

## Hardware Connections

**Warning! Do NOT remove the PM7513-R0 from the fiber box or open the fiber box. Opening the fiber box could damage the fiber optic cable. ONLY qualified service personnel should service or disassemble the PM7513-R0 and fiber box. Contact your ISP for further information.**

PM7513-R0 installed on the fiber box

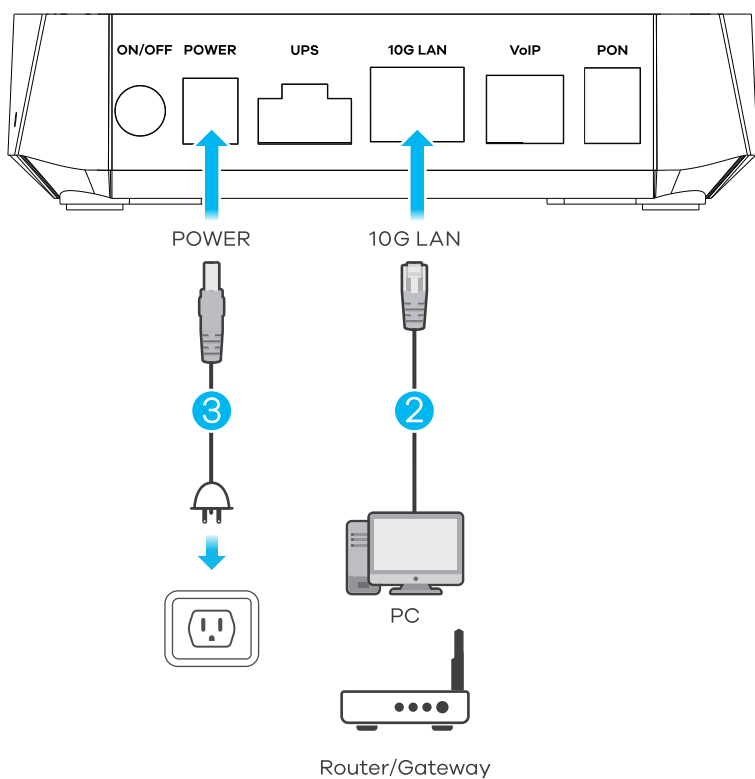

## Wall Mounting (Optional)

Technical drawing of the assembly showing dimensions and components:

- Top Component:** A screw with a length dimension of  $32.0-38.0$  mm and a head diameter dimension of  $6.5-7.5$  mm. The unit is mm.
- Bottom Component:** A screw with a length dimension of  $30.75-32.75$  mm and a head diameter dimension of  $7.5-8.0$  mm. The unit is mm.
- Assembly:** The two screws are shown being inserted into a rectangular block. The distance between the two screws is dimensioned as  $80\text{mm}$ .

2

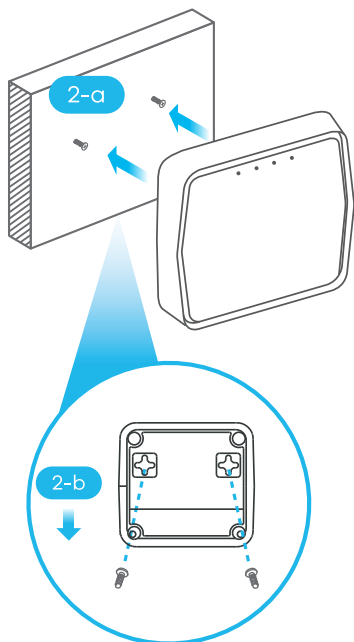

## Safety Warnings

Go to <http://x.x.x.x/safetyInfo> to display the safety warnings. Where "x.x.x.x" is the PM7513-R0's IP address.

PM7513-R0



Power Adapter

Ethernet  
Cable

## Quick Start Guide

See the User's Guide at <https://www.zyxel.com/service-provider/> for more information, including customer support and safety warnings.

## US Importer

Zyxel Communications, Inc  
1130 North Miller Street Anaheim, CA 92806-2001  
<https://www.zyxel.com/service-provider/>

Copyright © 2025 Zyxel Communications Corp. All Rights Reserved.

- ① Place the PM7513-R0 in the fiber box installed by the ISP.
- ② Connect a computer, router, or gateway to the **10G LAN** port using the white Ethernet cable.
- ③ Use the included power adapter to connect the power plug to a power outlet.

POWER	<p><b>Green On</b> - Device is turned on and has finished booting.</p> <p><b>Blinking</b> - Starting up.</p> <p><b>Red On</b> - System failure.</p> <p><b>Blinking</b> - Firmware upgrading.</p> <p><b>Off</b> - Not receiving power.</p>
UPS	<p><b>Green On</b> - The AC power is off and the UPS (battery backup) is providing power normally.</p> <p><b>Blinking</b> - The battery is working abnormally, such as the voltage going outside the expected range.</p> <p><b>Off</b> - The battery is not in use or cannot recharge.</p>
PON	<p><b>Green On</b> - PON link to the OLT is up. Receiving an optical signal of normal strength.</p> <p><b>Blinking</b> - Trying to establish a link to the OLT.</p> <p><b>Red On</b> - PON link to the OLT is down.</p> <p><b>Blinking</b> - The received optical signal is too weak.</p>
VoIP	<p><b>Green On</b> - A SIP account for outgoing calls is enabled and registered. The phone is on-hook and idle.</p> <p><b>Blinking</b> - The phone is off-hook or ringing for an incoming call.</p> <p><b>Amber On</b> - The phone is on-hook and idle and there is a voice message.</p> <p><b>Blinking</b> - The phone is off-hook or ringing for an incoming call and there is a voice message.</p> <p><b>Off</b> - The VoIP function is turned-off (deactivated) or a SIP account is not registered.</p>
10G LAN	<p>Located on the Ethernet connector.</p> <p><b>Green On</b> - Ethernet device connected.</p> <p><b>Blinking</b> - Transmitting/Receiving data.</p> <p><b>Off</b> - No Ethernet device connected.</p>

- ① Drill two holes on the wall at the distance of 80mm. Insert the screw anchors and screws (not provided).
- ② Place the PM7513-R0 so the wall mount holes line up with the screws (2-a). Slide the PM7513-R0 down gently to fix it into place (2-b).