

PM7510-R0
XGS-PON Bridge ONT with 10G LAN

Quick Start Guide

Package Contents

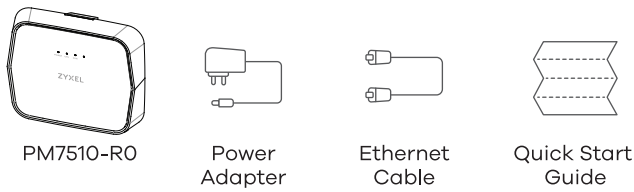

See the User's Guide at www.zyxel.com for more information, including customer support and safety warnings.

US Importer
Zyxel Communications, Inc
1130 North Miller Street Anaheim, CA 92806-2001
<https://www.zyxel.com/us/en/>

Copyright © 2022 Zyxel Communications Corp. All Rights Reserved.

Hardware Connections

1

A line drawing of the PM7510-R0 device, a small rectangular box with the ZYXEL logo, mounted on a larger rectangular fiber box.

PM7510-R0 installed on the fiber box

Warning! Do NOT remove the PM7510-R0 from the fiber box or open the fiber box. Opening the fiber box could damage the fiber optic cable. ONLY qualified service personnel should service or disassemble the PM7510-R0 and fiber box. Contact your ISP for further information.

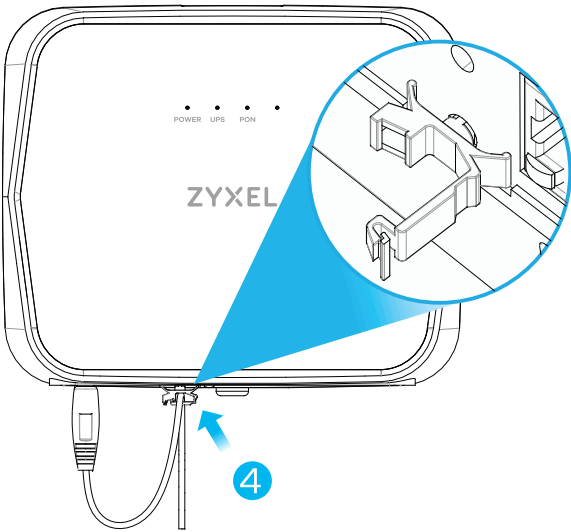
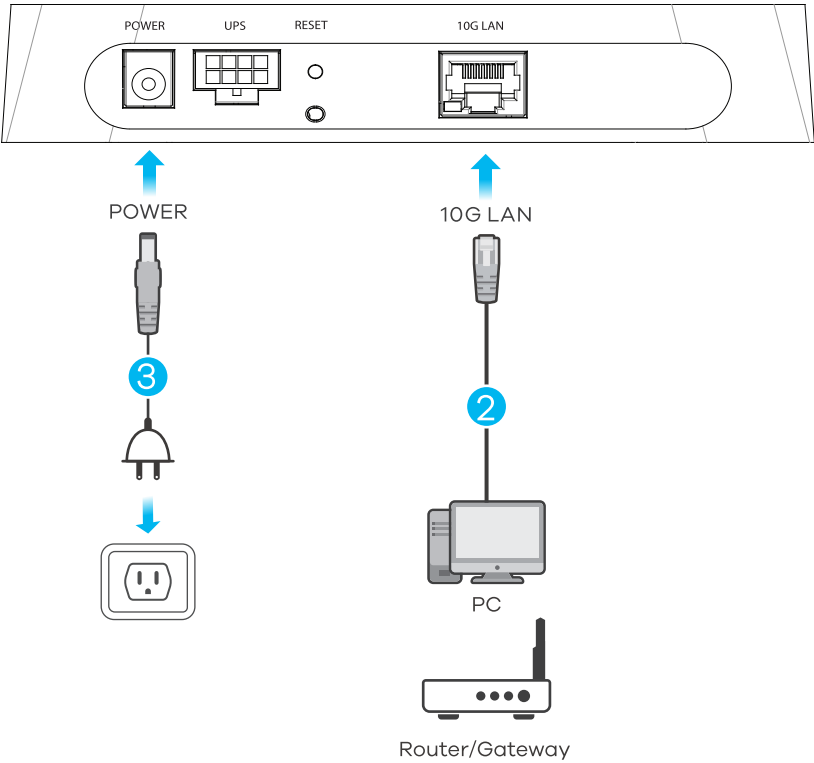

- ① Find the PM7510-R0 installed by the ISP on the fiber box.
- ② Connect a computer, router, or gateway to the **10G LAN** port using the white Ethernet cable.
- ③ Use the included power adapter to connect the power socket to a power outlet.
- ④ Press the cable clip to open it. Close it around the power adapter cable to prevent accidental unplugging.

POWER	<div>Green</div> On - Device is turned on and has finished booting. <div>Blinking</div> - Starting up. <div>Red</div> On - System failure. <div>Blinking</div> - Firmware upgrading. Off Not receiving power.
UPS	<div>Green</div> On - The AC power is off and the UPS (battery backup) is providing power normally. <div>Blinking</div> - The battery is working abnormally, such as the voltage going outside the expected range. Off The battery is not in use or cannot recharge.
PON	<div>Green</div> On - PON link to the OLT is up. Receiving an optical signal of normal strength. <div>Blinking</div> - Trying to establish a link to the OLT. <div>Red</div> On - PON link to the OLT is down. <div>Blinking</div> - The received optical signal is too weak.
10G LAN	Located on the Ethernet connector. <div>Green</div> On - Ethernet device connected. <div>Green</div> <div>Blinking</div> - Traffic. Off No Ethernet device connected.