



## NR5307

5G NR Indoor Router



## Quick Start Guide

ENGLISH

## Support Information

<https://service-provider.zyxel.com/global/en/tech-support>



See the User's Guide at [www.zyxel.com](http://www.zyxel.com) for more information, including customer support and safety warnings.

### EU Importer

Zyxel Communications A/S  
Gladsaxevej 378, 2. th. 2860 Søborg, Denmark

### UK Importer

Zyxel Communications UK Ltd.  
2 Old Row Court, Rose Street, Wokingham, RG40 1XZ, United Kingdom (UK)

Copyright © 2024 Zyxel and/or its affiliates.  
All Rights Reserved.



## Package Contents



Zyxel Device

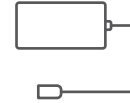

Power Adapter

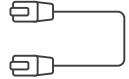

Ethernet Cable



Quick Start Guide



Declaration of Conformity  
Safety Warnings

# 1

## Hardware Installation

1

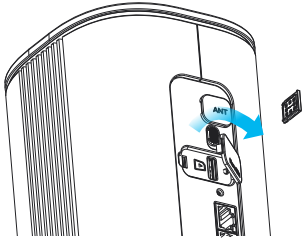

2

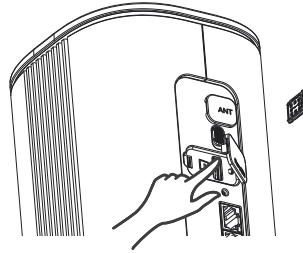

3

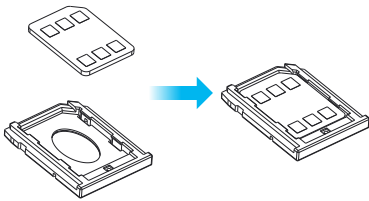

4

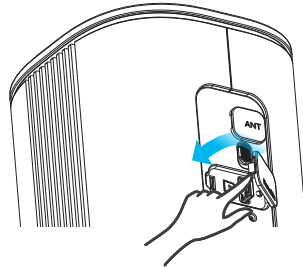

- ① Make sure the Zyxel Device is turned off. On the side of the Zyxel Device, open the cover of the nano SIM card slot.
- ② Push and pull the SIM card tray out of the SIM card slot.
- ③ Place the nano SIM card on the tray, with the chip facing up.
- ④ Gently push the SIM card tray into the SIM card slot. Put the cover back in place.

# 1

## Hardware Installation

5

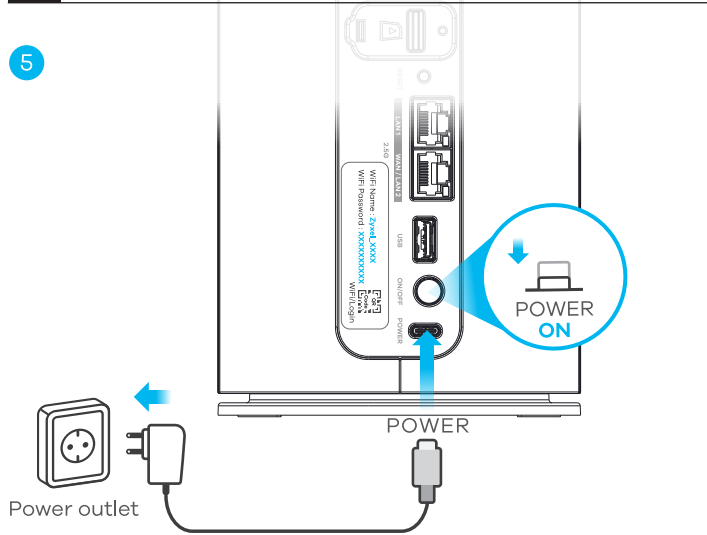

6

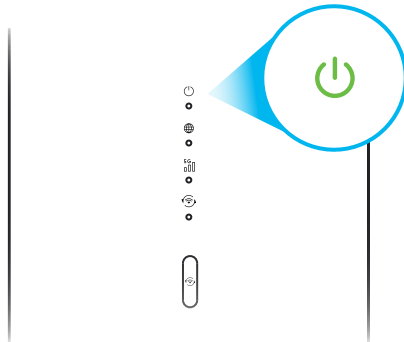

- 5 Select the type of power plug used in your country. Use the included power adapter to connect the power socket to an appropriate power source. Press the **ON/OFF** button to turn on the Zyxel Device.
- 6 Check that the POWER LED is already on.

## 2

# Network Connections

### 7-a Manual Connection (using SSID)

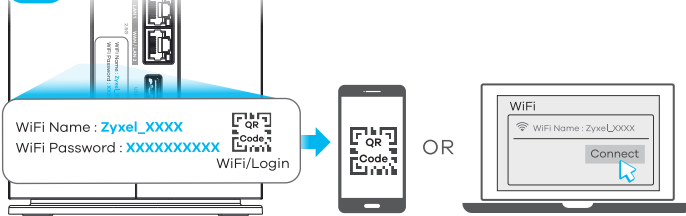

### 7-b Automatic Connection (Using WPS)

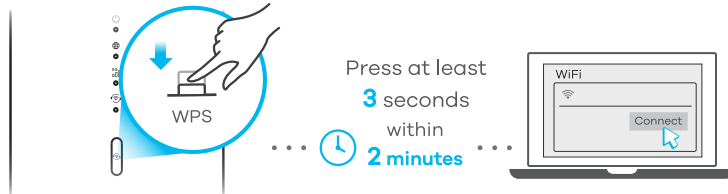

**Green Blink** - Establishing WPS connection  
**On** - WLAN interface is enabled

### 7-c Or Using Ethernet Cable

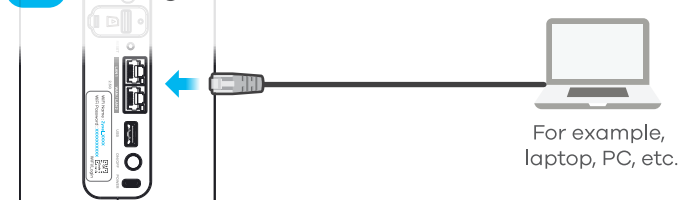

- 7-a Find the **WiFi Name** and the **WiFi Password**. On your smartphone or laptop, find this **WiFi Name**. Enter the **WiFi Password** to connect. On your mobile device, scan the QR code then follow the prompts to connect to the Zyxel Device WiFi network.
- 7-b To set up a secure WiFi connection between the Zyxel Device and a wireless client using WPS, press the WPS button on the front of the Zyxel Device for at least 3 seconds. Press the WPS button on the client within 2 minutes. If the WPS method fails, use the **WiFi Name** and **WiFi Password** to set up a WiFi connection.
- 7-c Use an Ethernet cable to connect a computer to one yellow LAN port of the Zyxel Device.

### 3

## Configuration

8-a



WiFi/Login

Web login address : 192.168.1.1

Username/Password : admin/XXXXXXXXXX

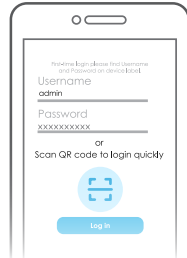

8-b



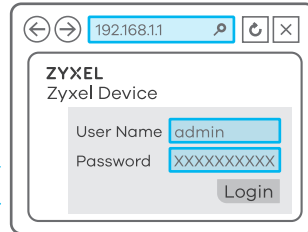

Web login address : 192.168.1.1

Username/Password : admin/XXXXXXXXXX



- 8-a 1. You can download the Zyxel One app or use the Web Configurator (see the next step) to manage the Zyxel Device.  
2. To log into the Zyxel One app for the first time, scan the Login QR code or enter the admin username and password from the Zyxel Device label.
- 8-b Open a web browser and go to <https://192.168.1.1>. Enter the admin username and password from the Zyxel Device label, then click **Login**.

## LEDs

 Power/ System	<p><b>Blue On</b> - There is one or more unread SMS messages. <b>Blink</b> - SMS inbox is full.</p> <p><b>Green Blink</b> - The Zyxel Device is booting.</p> <p><b>On</b> - The power is on. <b>Off</b> - The power is off.</p> <p><b>Red On</b> - There is an error, contact your service provider.</p>
 Internet	<p><b>Blue On</b> - The Internet is connected using 5G.</p> <p><b>Green On</b> - The Internet is connected using 4G or Ethernet WAN.</p> <p><b>Red</b> - The Internet is unavailable.</p>
 Cellular Signal Strength	<p><b>Blue On</b> - The signal strength is good. <b>Blink</b> - No SIM card or an invalid SIM card.</p> <p><b>Green On</b> - The signal strength is fair.</p> <p><b>Red On</b> - The signal strength is poor. <b>Blink</b> - There is no cellular signal or it is too weak to be detected.</p>
 WiFi/WPS	<p><b>Green Blink</b> - The Zyxel Device is establishing WPS connection.</p> <p><b>On</b> - The WLAN interface is enabled. <b>Off</b> - The WLAN interface is disabled.</p>
All LEDs	<p><b>Green Blink</b> - Resetting to factory default settings or upgrading firmware.</p>

## Troubleshooting

### Power and Hardware Connections

- Make sure SIM card is correctly installed in Zyxel Device.
- Make sure the power adapter is connected correctly.

### Zyxel Device Access and Login

- Make sure you are using the correct IP address.
  - The default IP address is 192.168.1.1.
  - If you changed the IP address and have forgotten it, reset the Zyxel Device to factory defaults by pressing **RESET** button for more than 5 seconds.
- Make sure your Internet browser does not block pop-up windows and has JavaScript enabled.
- Make sure you enter the username and password correctly. The default username and password are printed on the Zyxel Device label. If they do not work, reset the Zyxel Device to its factory defaults by pressing the **RESET** button for more than 5 seconds.

### Internet Access

- Make sure you insert a 5G/LTE SIM card into the card slot before turning on the Zyxel Device.
- Log into the Web Configurator. Click Setup Wizard, then check the setting in Step 2 WiFi Setup.
- Make sure 5G/LTE SIM card's account is valid and has an active data plan.
- When using a pre-paid SIM card, insert SIM card on another 5G/LTE device to check if SIM card still works. If SIM card works on another 5G/LTE device, contact the vendor. If SIM card does not work, contact your service provider.

### WiFi Connections

- Make sure WiFi is enabled on the Zyxel Device.
- Make sure wireless adapter (installed on your computer) works.

### 5G/LTE Connections

- Make sure SIM card's account is valid and has an active data plan.